

# OneStop® Eco Specifications

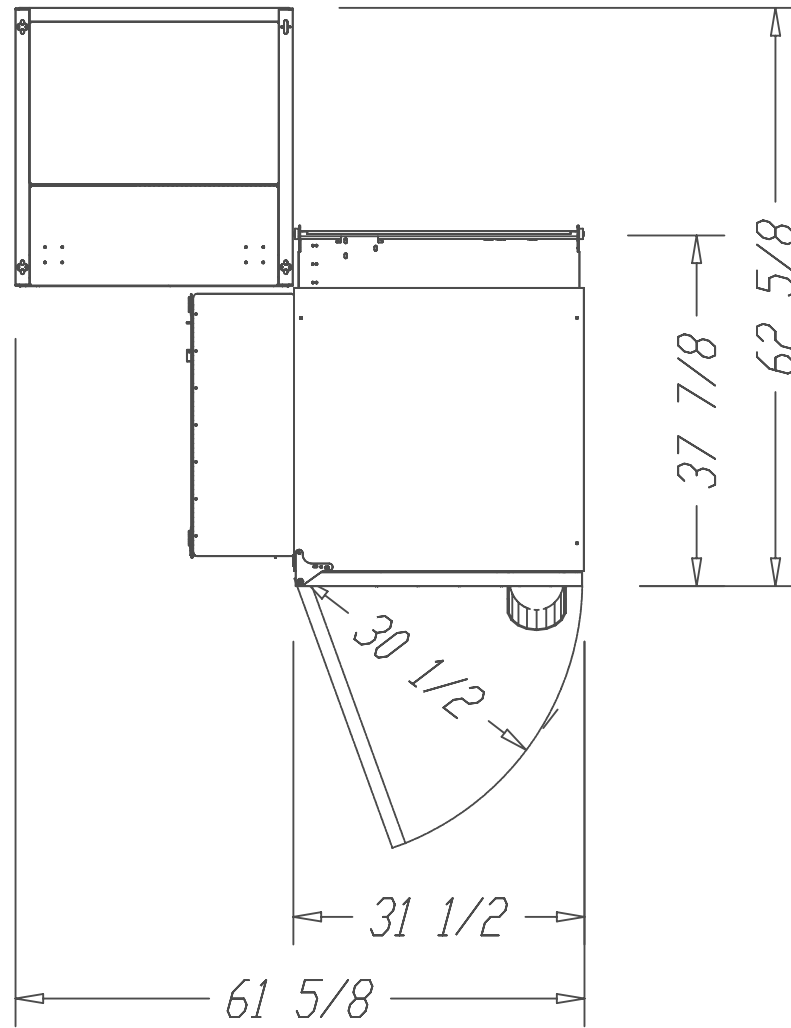

TOP VIEW

## OneStop® Eco with rear glass and rear unload

**NOTE: This option is for a through wall installation only.**

2525 SE Stubb St., Milwaukie, OR 97222  
fax 503-232-8453 | sales@canandbottle.com | www.canandbottle.com  
OneStop® Eco is a registered trademark of Can & Bottle Systems, Inc.



# OneStop® Eco Specifications

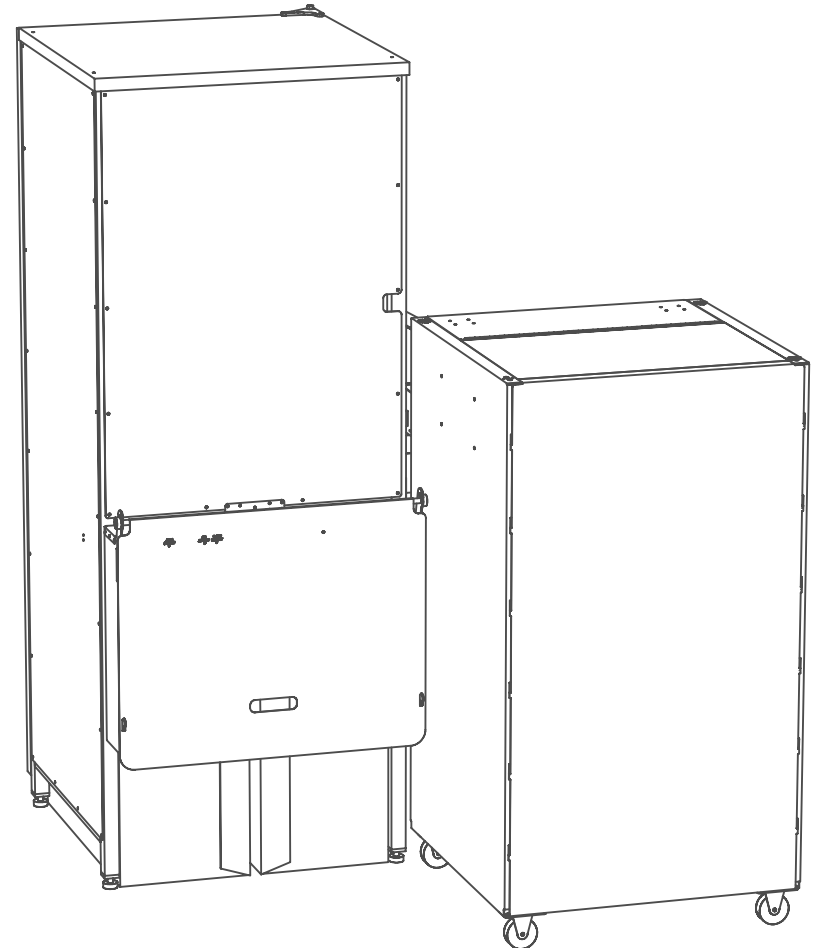
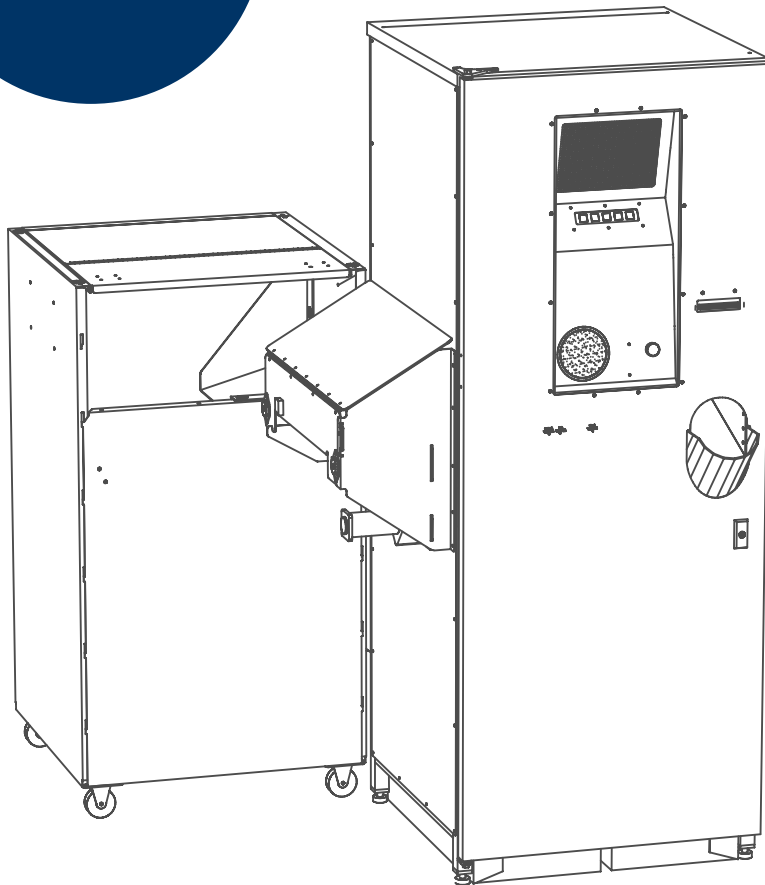

## OneStop® Eco with rear glass and rear unload

**NOTE: This option is for a through wall installation only.**

2525 SE Stubb St., Milwaukie, OR 97222  
fax 503-232-8453 | [sales@canandbottle.com](mailto:sales@canandbottle.com) | [www.canandbottle.com](http://www.canandbottle.com)  
OneStop® Eco is a registered trademark of Can & Bottle Systems, Inc.

